

winter garden systems

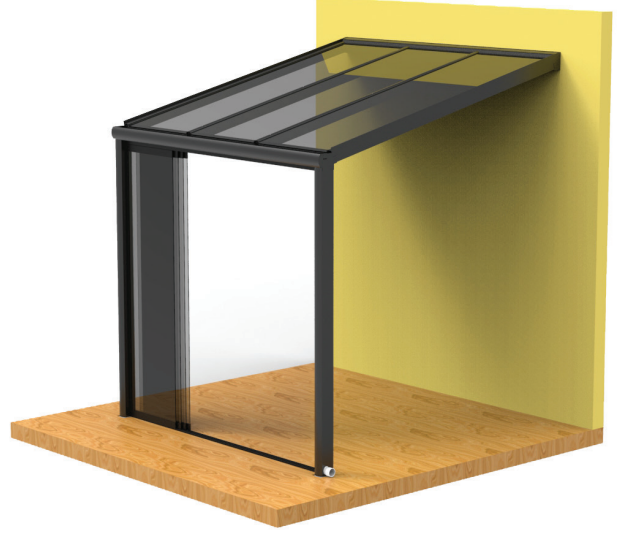

kış bahçesi  
sistemleri

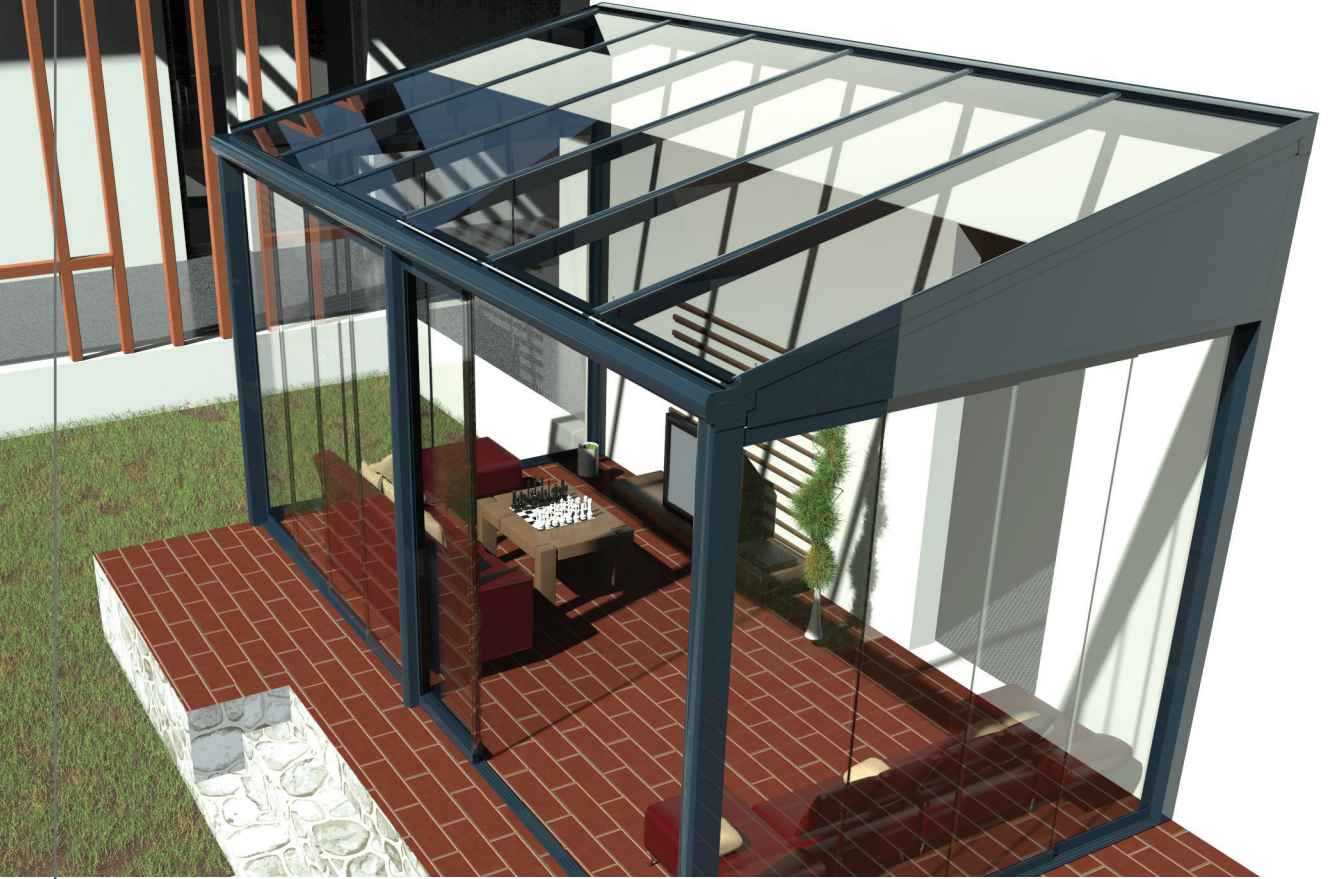

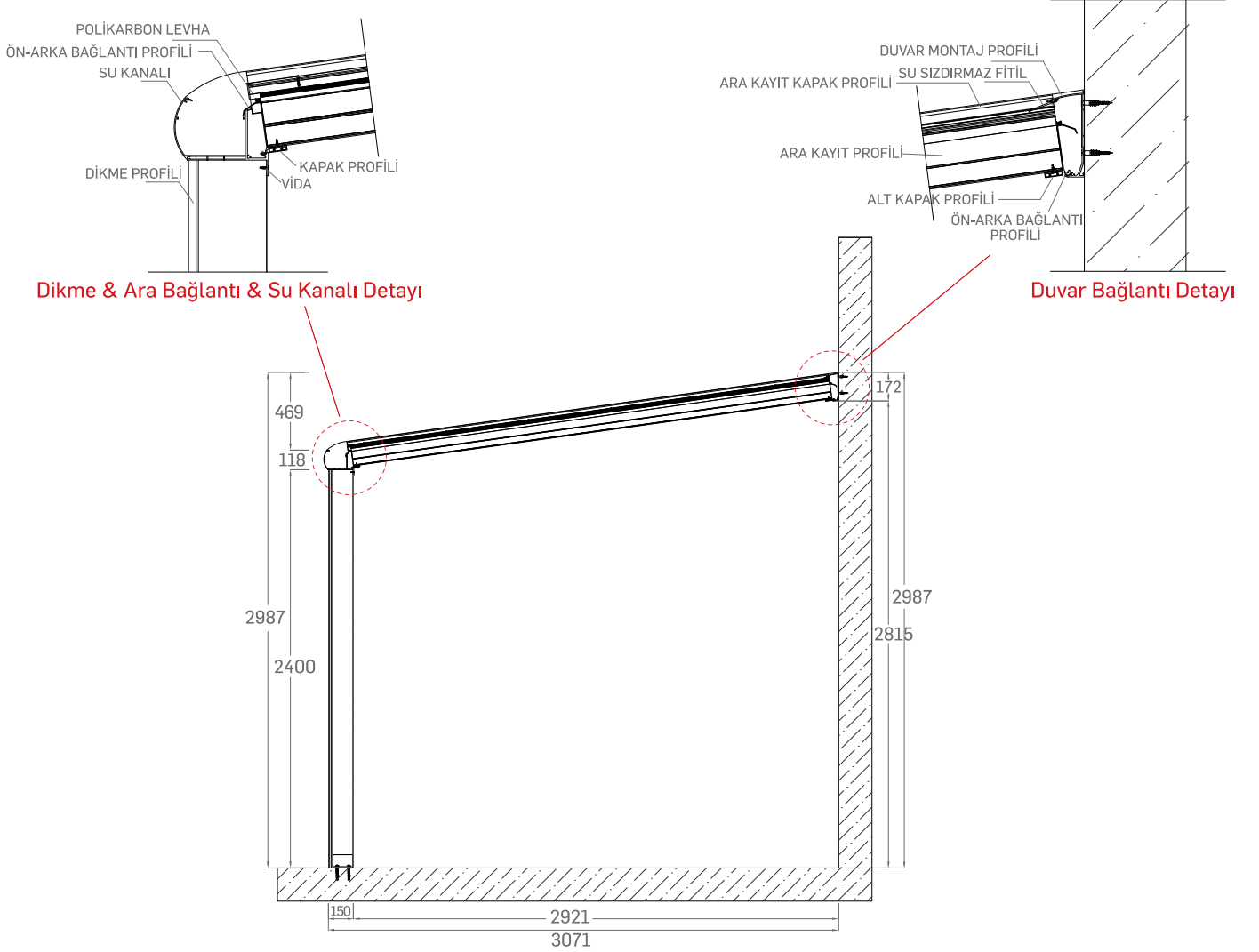

## ARFEN Kış Bahçesi Sistemleri

Arfen kış bahçesi sistemimiz müstakil konutlar için uygun olmakla birlikte boş arazilerinizde özel kullanım için de kış bahçesi yaptırabilirsiniz. Sistem uygulamalarımız villa tipi müstakil yapılar ile birlikte yapılabildiği gibi ayrı olarak da uygulaması ve imalatı yapılabilmektedir. Konforun ve kalitenin her mevsim devam edebilmesi için kış bahçesi sistemimiz çok iyi bir tercihtir. Kertme ve açılı kesime ihtiyaç olmadan kurulmasının vermiş olduğu kolaylık, kullanıcıların tercihinde önemli bir rol almaktadır.

Arfen winter garden system is suitable for detached houses, you can also have a winter garden for private use on your empty lands. Our system applications can be made together with villa type detached structures, as well as separately applied and manufactured. Our winter garden system is a very good choice for comfort and quality to continue in all seasons. The convenience of installing without the need for chamfering and angled cutting plays an important role in the preference of users.

- Hızlı imalat ve montaj kolaylığı
- Güçlü ve korozyon dayanımı yüksek
- 8–30 mm aralığında cam, polikarbon veya alüminyum kullanımı
- Açılı profili ile 8° - 20° derece arası uygulama olanağı
- Bütün profillerin 90° kesime uygunluğu
- Çelik takviye kullanma seçeneği
- Uygulanabilir mat eloksal ve RAL renkleri

- Fast manufacturing and easy assembly
- Strong and corrosion resistant
- Use of glass, polycarbonate or aluminum in the 8 – 30 mm range
- Possibility of application between 8° and 20° degrees with its angled profile
- Suitability of all profiles for 90° cutting
- Option to use steel reinforcement
- Applicable matt anodized and RAL colors

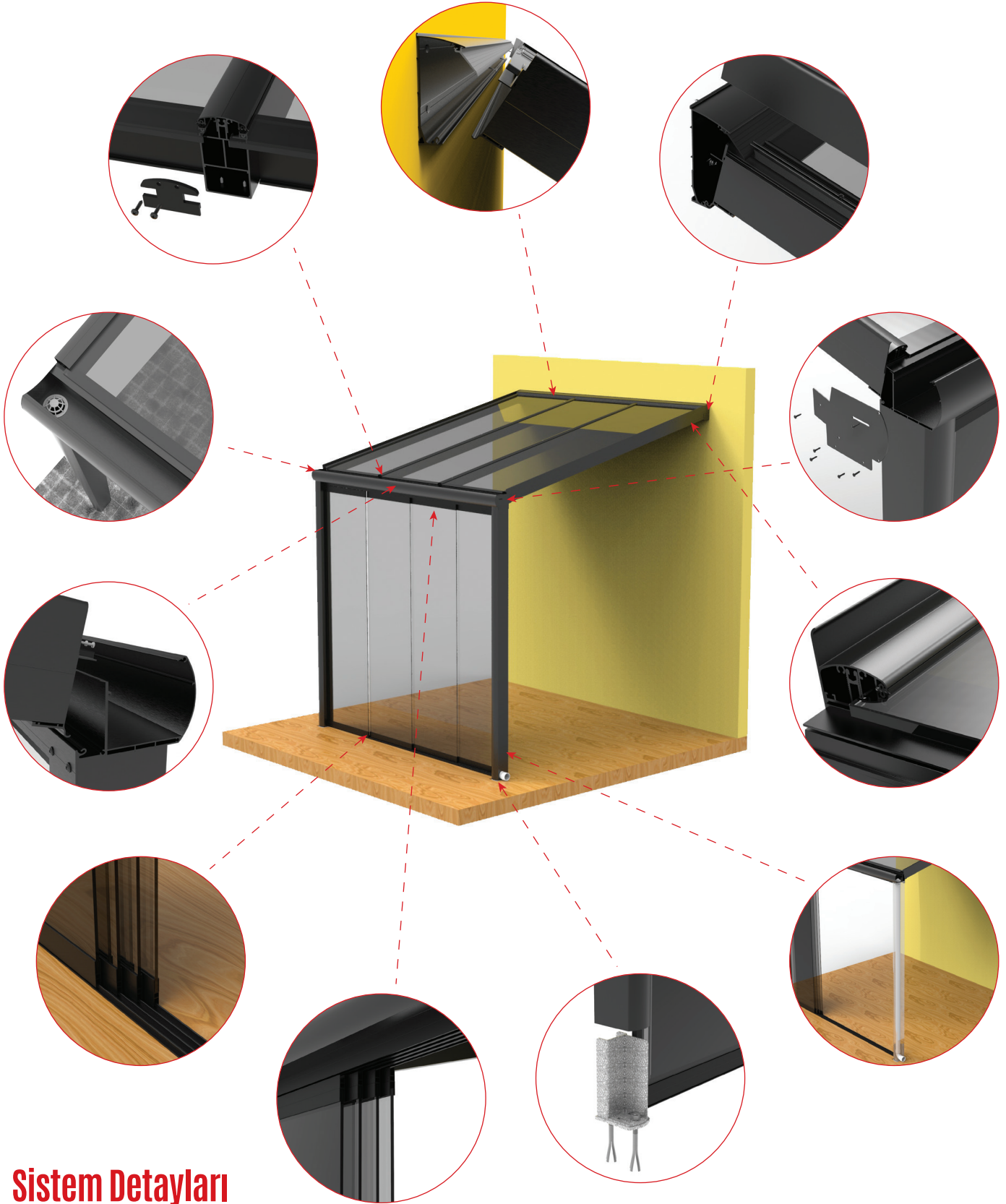

**Sistem Detayları**  
System Details



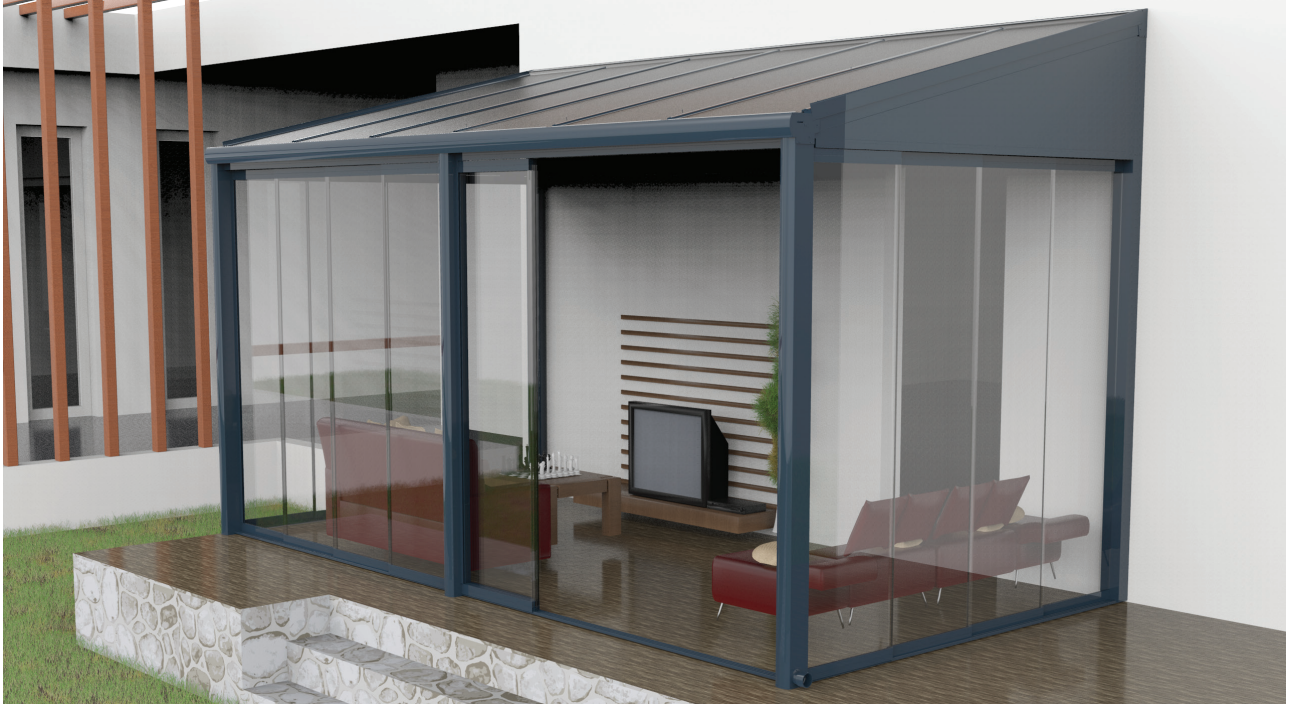

## Uygulama Aşamaları

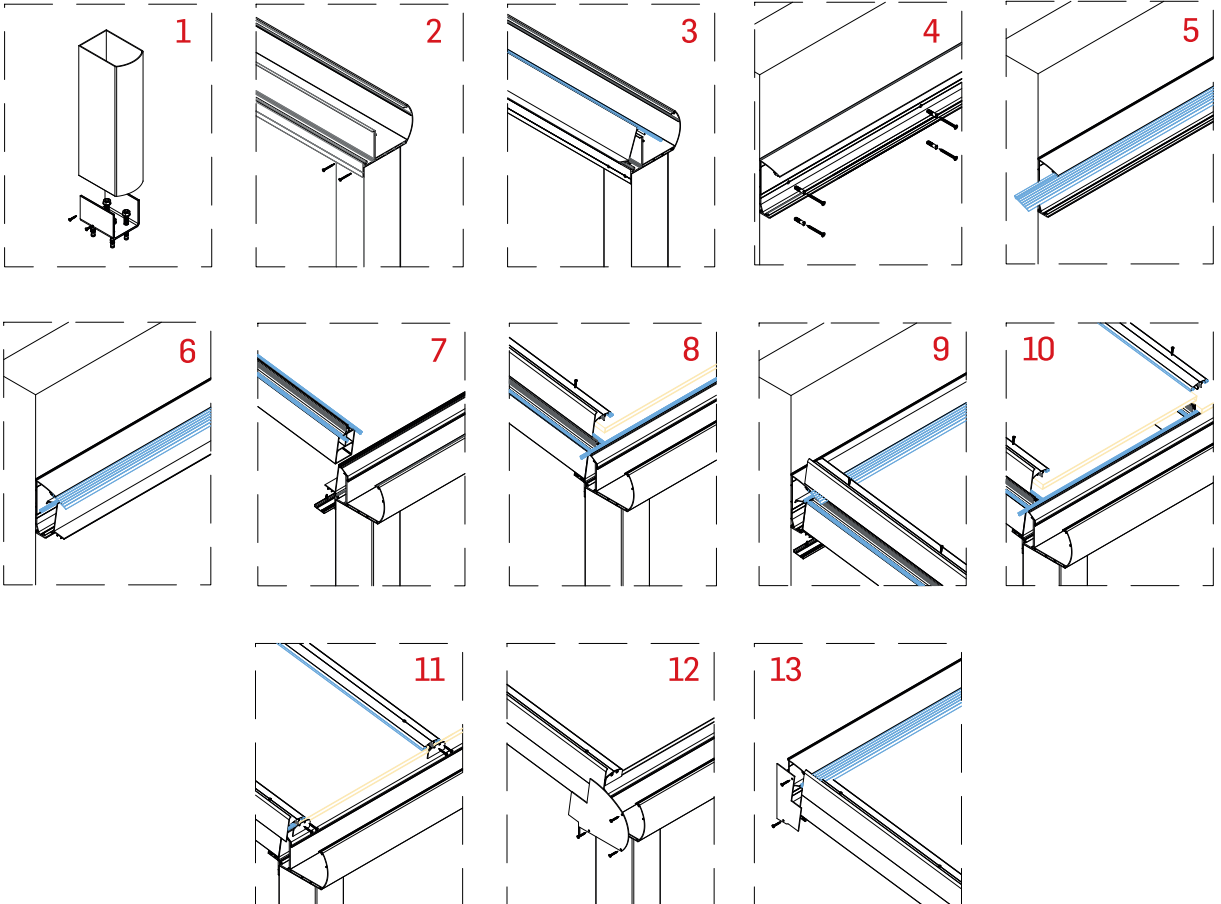



## Profiller

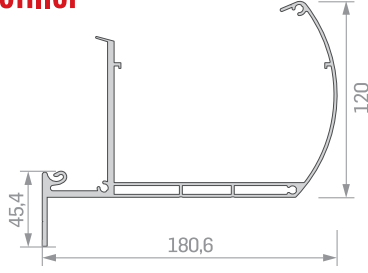

**1656**  
Oluk Profili  
BORDER PROFILE  
Ağırlık / Weight: 4,046

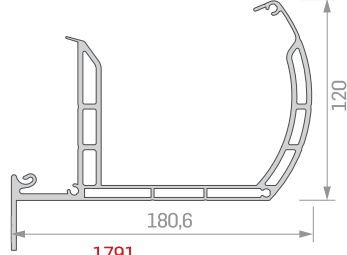

**1791**  
Oluk Profili  
BORDER PROFILE  
Ağırlık / Weight: 5,742

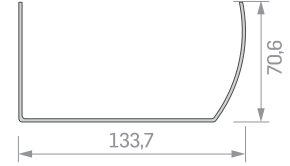

**1661**  
Oluk Destek Profili  
BORDER SUPPORT PROFILE  
Ağırlık / Weight: 1,131

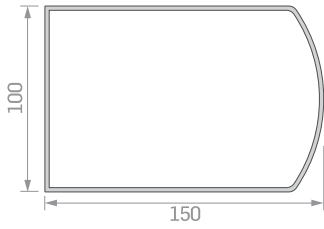

**1657**  
Kapaksız Kolon Profili  
COLUMN PROFILE WITHOUT COVER  
Ağırlık / Weight: 2,905

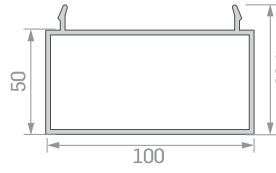

**1790**  
Kapaklı Kolon Alt Profili  
COLUMN BELOW PROFILE WITH COVER  
Ağırlık / Weight: 1,976

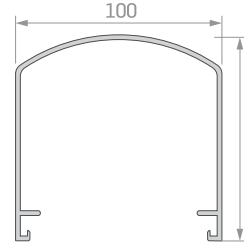

**1789**  
Kapaklı Kolon Üst Profili  
COLUMN UPPER PROFILE WITH COVER  
Ağırlık / Weight: 1,875

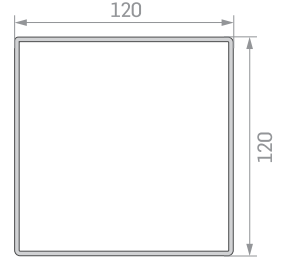

**1695**  
Kare Kolon Profili  
SQUARE COLUMN PROFILE  
Ağırlık / Weight: 3,165

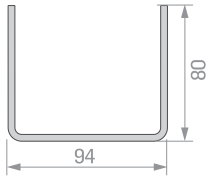

**1659**  
Kolon İçi U Profil  
COLUMN INSIDE U PROFILE  
Ağırlık / Weight: 2,615

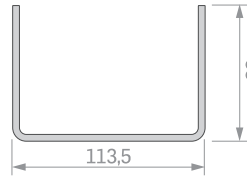

**1745**  
Kare Kolon İçi U Profil  
SQUARE COLUMN INSIDE U PROFILE  
Ağırlık / Weight: 2,821



**5769**  
Duvar Sabitleme Profili  
WALL FIXING PROFILE  
Ağırlık / Weight: 2,192



**1658**  
Duvar Sabitleme Profili  
WALL FIXING PROFILE  
Ağırlık / Weight: 2,086

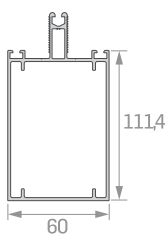

**5770**  
Griyaj Profili  
GRIYAJ PROFILE  
Ağırlık / Weight: 1,799

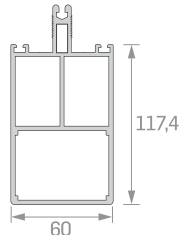

**1653**  
Griyaj Profili  
GRIYAJ PROFILE  
Ağırlık / Weight: 2,724

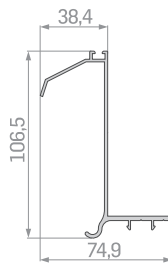

**5707**  
Geçme Açı Profili  
ANGLE PROFILE  
Ağırlık / Weight: 1,073

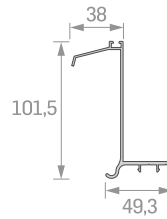

**5773**  
Geçme Açı Profili  
ANGLE PROFILE  
Ağırlık / Weight: 1,027

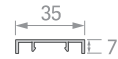

**5298**  
LED Kapak Profili  
LED COVER PROFILE  
Ağırlık / Weight: 0,201

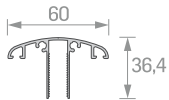

**5771**  
Griyaj Kapak Profili  
GRIYAJ COVER PROFILE  
Ağırlık / Weight: 0,634

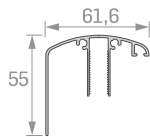

**5772**  
Griyaj Kenar Kapak Profili  
GRIYAJ EDGE COVER PROFILE  
Ağırlık / Weight: 0,748

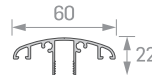

**1654**  
Griyaj Kapak Profili  
GRIYAJ COVER PROFILE  
Ağırlık / Weight: 0,545

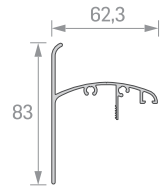

**1660**  
Griyaj Kenar Kapak Profili  
GRIYAJ EDGE COVER PROFILE  
Ağırlık / Weight: 0,919

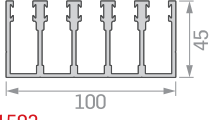

**1592**  
4 Kanallı Kalın  
Sürme Üst Kasa Profili  
SLIDING THICK FRAME UPPER  
PROFILE WITH 4 CHANNELS  
Ağırlık / Weight: 2,948

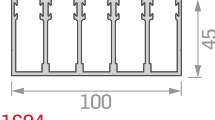

**1604**  
4 Kanallı İnce  
Sürme Üst Kasa Profili  
SLIDING THIN FRAME UPPER  
PROFILE WITH 4 CHANNELS  
Ağırlık / Weight: 2,504

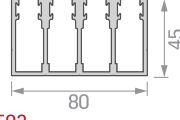

**1593**  
3 Kanallı Kalın  
Sürme Üst Kasa Profili  
SLIDING THICK FRAME UPPER  
PROFILE WITH 3 CHANNELS  
Ağırlık / Weight: 2,488

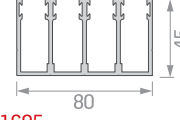

**1605**  
3 Kanallı İnce  
Sürme Üst Kasa Profili  
SLIDING THIN FRAME UPPER  
PROFILE WITH 3 CHANNELS  
Ağırlık / Weight: 2,038

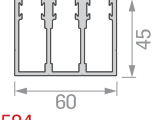

**1594**  
2 Kanallı Kalın  
Sürme Üst Kasa Profili  
SLIDING THICK FRAME UPPER  
PROFILE WITH 2 CHANNELS  
Ağırlık / Weight: 1,827

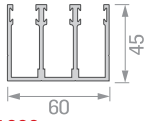

**1606**  
2 Kanallı İnce  
Sürme Üst Kasa Profili  
SLIDING THIN FRAME UPPER  
PROFILE WITH 2 CHANNELS  
Ağırlık / Weight: 1,572

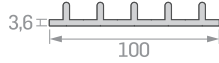

**1584**  
5 Kanallı Eşiksiz Alt Sürme Profili  
SLIDING FRAME LOWER  
PROFILE NON-THRESHOLD  
WITH 5 CHANNELS  
Ağırlık / Weight: 1,466

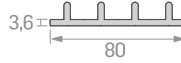

**1595**  
4 Kanallı Eşiksiz Alt Sürme Profili  
SLIDING FRAME LOWER  
PROFILE NON-THRESHOLD  
WITH 4 CHANNELS  
Ağırlık / Weight: 1,173

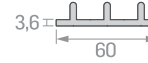

**1596**  
3 Kanallı Eşiksiz Alt Sürme Profili  
SLIDING FRAME LOWER  
PROFILE NON-THRESHOLD  
WITH 3 CHANNELS  
Ağırlık / Weight: 0,851

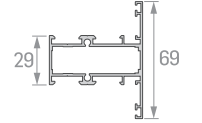

**1598**  
Orta Kayıt Profili  
MIDDLE RECORD PROFILE  
Ağırlık / Weight: 1,060

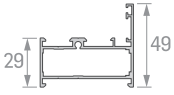

**1599**  
L Kasa Profili  
L SHAPE FRAME PROFILE  
Ağırlık / Weight: 0,864



**1597**  
Tip 1 Kanat Profili  
TYPE 1 WING PROFILE  
Ağırlık / Weight: 0,829



**1603**  
Tip 2 Kanat Profili  
TYPE 2 WING PROFILE  
Ağırlık / Weight: 0,927



**1600**  
4+4 mm Cam Çıtası  
4+4 mm GLAZING  
BEAD PROFILE  
Ağırlık / Weight: 0,320



**1601**  
5+5 mm Cam Çıtası  
5+5 mm GLAZING  
BEAD PROFILE  
Ağırlık / Weight: 0,290



**1602**  
Geniş Bitim U Profili  
WIDE END U PROFILE  
Ağırlık / Weight: 0,385



**1744**  
Dar Bitim U Profili  
NARROW END U PROFILE  
Ağırlık / Weight: 0,374

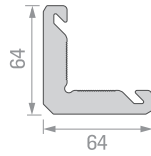

**1632**  
Köşe Çavuş Profili  
CORNER END PROFILE  
Ağırlık / Weight: 3,900

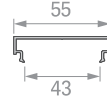

**1643**  
5+5 mm Cam Çıtası  
5+5 mm GLAZING  
BEAD PROFILE  
Ağırlık / Weight: 0,317



**2723**  
Ağırlık /  
Weight: 0,160

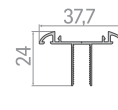

**2926**  
Ağırlık /  
Weight: 0,512

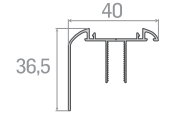

**2925**  
Ağırlık /  
Weight: 0,688

## Aksesuar ve Fitiller



**205.8058**  
Dış Cam Fitili



**WDA-901**  
3 mm Kama Fitili



**WDA-902**  
4 mm Kama Fitili



**WDA-903**  
5 mm Kama Fitili



**WDA-904**  
6 mm Kama Fitili



**Kapak Üst Fitili**



**Griyaj Kanal Fitili**

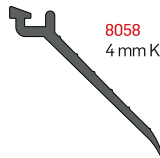

**8058**  
4 mm Kama Fitili

