

seramik cephe yapıştırma sistem profilleri

ceramic facade bonding system profiles

1. L Braket
1. L Bracket
2. T Profil
2. T Profile
3. Yapıştırıcı
3. Adhesive
4. Yatay Derz Profili
4. System Profile
5. Düşey Derz Profili
5. System Profile
6. Seramik & Taş
6. Ceramic & Stone
7. Trapez Vida
8. Trapeze Screw
8. Çelik Dübel
8. Steel Anchor
9. Opsiyonel Termal Bariyer
9. Optional Thermal Breaker

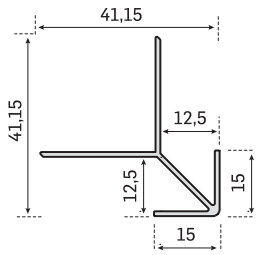
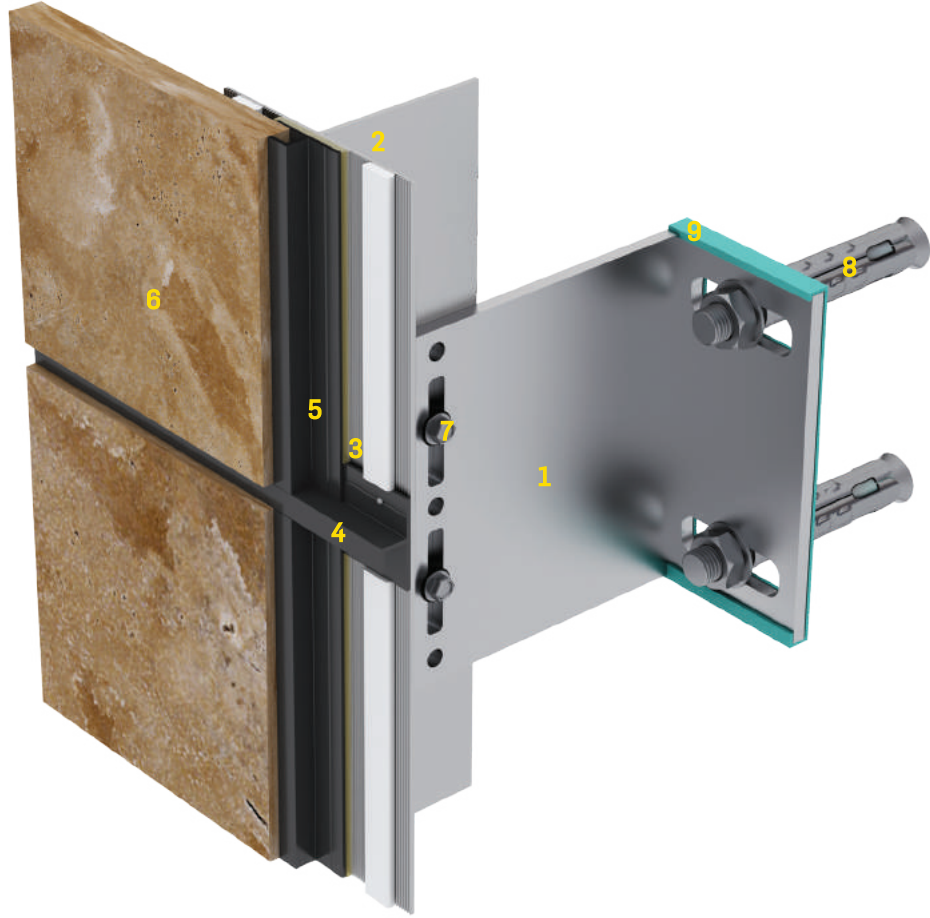

4057 - 0,298 kg/mt

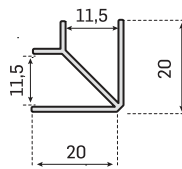

4056 - 0,200 kg/mt

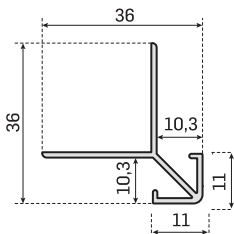

1673 - 0,279 kg/mt

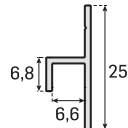

4058 - 0,125 kg/mt

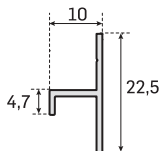

1675 - 0,106 kg/mt
Yatay Derz

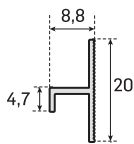

1674 - 0,089 kg/mt
Düşey Derz

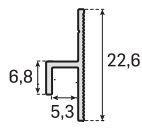

4059 - 0,106 kg/mt

